

:management centre

Seclusion and superb training facilities at the Keele Management Centre.

Key people require key training initiatives. When you want to give time and space to senior personnel, the Management Centre is tailor-made.

Set in scenic Keele village away from the activity of the main campus, the Management Centre is a hidden gem. Behind the handsome façade of this elegant Victorian building is a self-contained, purpose-designed management facility.

Available throughout the year, the Management Centre caters for groups of up to 100 people and houses a series of contemporary seminar rooms featuring the latest audio and visual technologies. Full business centre and office support services are available and a café-style lounge adds sleek break-out space with comfortable seating and internet stations. The lounge doors provide easy access to the attractive gardens.

Hotel standard accommodation is available at the centre with 39 well-appointed en suite bedrooms. Also at the centre, Hawthorns Restaurant serves a full selection of meals and refreshments throughout the day. Everything you need is right here.

What better setting for a little blue sky thinking?



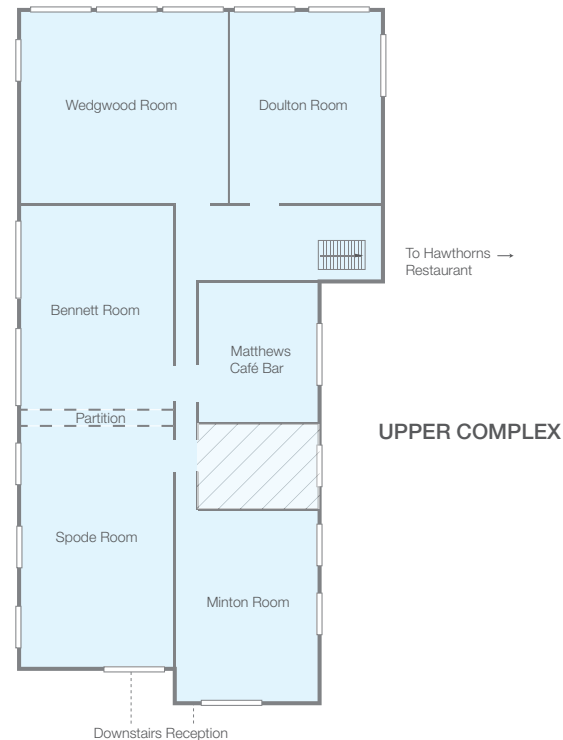
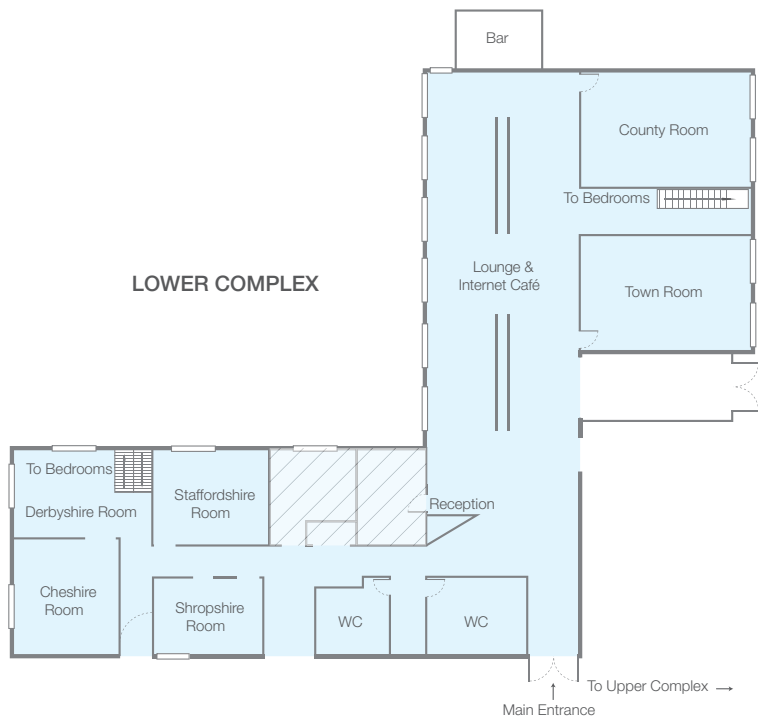

Keele Management Centre features

All rooms come equipped with the following:

- Flipcharts, pads and pens
- Chilled water
- OHP and screen
- Natural light or blackout option

Additional options for the meeting rooms are available including:

- LCD projector
- Laptop/PC
- Video/DVD
- Plasma screen
- Internet connection

KEELE MANAGEMENT CENTRE	Dimensions (m)	Electrical Points	Boardroom	Hollow Square	Theatre	Cabaret	U Shape with tables	Lounge Style
Lower Complex								
Cheshire Room	4.9 x 4.2	8	10	12	n/a	n/a	9	7
Shropshire Room	4.9 x 3	2	8	n/a	n/a	n/a	n/a	5
Staffordshire Room	4.1 x 4	4	8	8	n/a	n/a	6	5
Derbyshire Room	2.8 x 3.9	3	6	n/a	n/a	n/a	n/a	5
Town Room	6.5 x 7.4	2	18	22	36	24	18	n/a
County Room	6.5 x 7.4	2	18	22	36	24	18	n/a
Upper Complex								
Spode Room	8.8 x 9.7	3	24	36	96	30	27	n/a
Bennett Room	8.8 x 7.1	3	20	32	48	18	18	n/a
Spode & Bennett Room Linked	8.8 x 16.8	6	n/a	n/a	144	42	n/a	n/a
Wedgwood Room	6 x 11	5	20	30	64	24	24	n/a
Doulton Room	6 x 7.7	3	16	24	40	18	16	n/a
Minton Room	7.4 x 9	3	20	36	70	24	24	n/a
Michelin Room*	6.4 x 8.8	5	16	24	30	18	18	n/a

* This room and the main restaurant do not appear on the above plans, please speak to your Event Organiser for more details.